



IEI Technology Corp.



**EBC-2100**

**EPIC-NANO Series Embedded Board Chassis**

**Quick Installation Guide**

Version 1.1 January 24, 2006

**Product Dimensions**

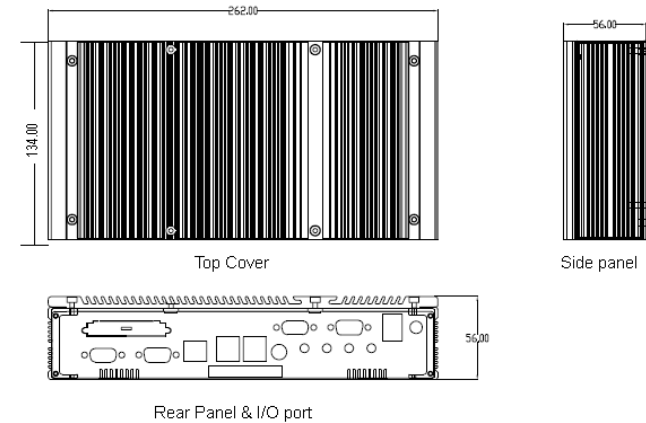

**Product Specification**

Material & Thickness	Cover/Base Brackets	AL 3.2mm / 1.0mm SECC 2.0mm
Support Embedded Board	IEI EPIC-NANO	NANO-7240 series NANO-7270G series NANO-7270-600 series NANO-7270-PM733 series
I/O Interface		COM x(1 + 2), VGAx1, LANx1, CFx1, PS/2x1, USBx4, Audiox4, LPTx1, Power Switchx1, Power Jack x 1
Internal Drive Bay		2.5" HDD
Color		Pantone Gray 7C
Expansion Slots		Support PC/104 or PC/104+ module space
Shock	Operating	3G acceleration peak to peak (11ms)
	Non-Operating	10G acceleration peak to peak (11ms)
Vibration	Operating	10~57Hz, 0.006" double amplitude displacement 57~500Hz, 1.0G acceleration peak to peak
	Non-operating	5~17Hz, 0.1" double amplitude displacement 17~640Hz, 1.5G acceleration peak to peak
Chassis Dimension		D134xW262xH56 mm      D5.27"xW10.3"xH2.2"
Net Weight / Gross Weight		1 / 3 (kg)                      2.1 / 6.3 (lb)
CFM / CUFT		2.986CFM                      0.6329cuft

**Packing Content**



A. Chassis x 1 pcs



B. QIG



C. Screws



D. Wall Mounting Kits

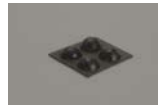

E. Rubber Foot Pad



F. Power Adapter with Power Cord



Optional Peripherals

**A.1 Optional Socket type CPU Heatsink Module (P/N: 34000-000060-RS)**

AL+CU Heatsink with screws

**A.2 Optional Cooling Fan Module (P/N: 19100-000027-RS)**

40x40x10mm, +12V ball bearing Fan; 3 Pin; 6000RPM with screws

**A.3 Optional IDE cable (P/N: 32200-000037-RS)**

44pin IDE cable for 2.5" HDD

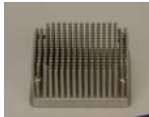

A.1



A.2



A.3

Recommendation of System cooling Components

recommended  must-have

Board Model Code	CPU	Board Companion Heatsink	Heatsink 34000-000060-RS	System fan 19100-000027-RS
NANO-7240-400 -R10	ULV Intel Celeron 400MHz	<input checked="" type="checkbox"/>		<input type="checkbox"/>
NANO-7270G-R11	Socket 479 base Pentium M/ Celeron M CPU up to 1.8GHz <sup>#1</sup>		<input checked="" type="checkbox"/>	<input checked="" type="checkbox"/>
NANO-7270-600-R11	ULV Intel Celeron M	<input checked="" type="checkbox"/>		<input type="checkbox"/>
NANO-7270-600Z-R11	600MHz	<input checked="" type="checkbox"/>		

**#1 Operation Temperature: 0°C ~ 40°C**

**Installing NANO-7270G-R11 with Pentium M 2.0GHz CPU into EBC-2100 is not recommended due to thermal issue.**

Hardware Installation

The following procedures demonstrate the installation of EBC-2100. Please read the precautions carefully before installing it.

**Precautions**

1. Always disconnect the unit from the power outlet whenever installing or fixing a component inside the chassis.
2. If possible, always wear a grounded wrist strap when installing or fixing a component inside the chassis.
3. Hold electronic circuit boards (EPIC-NANO board) by the edges only. Do not touch the components on the board unless it is necessary.
4. Use the correct screws and never overly tighten them.
5. Keep the whole set original package in case the unit has to be returned.

**Step 1**

Remove eight screws from the cover by screwdrivers.

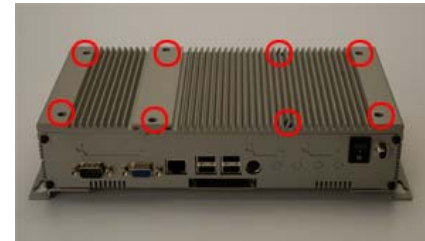

**Step 2**

Remove the plastic shield inside the chassis.

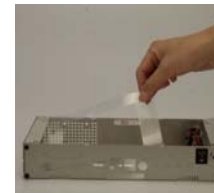

**Step 3**

If additional hard drive storage is required, simply remove the HDD bracket from the chassis. Then connect the hard drive to the HDD bracket, plug the HDD cable to the hard drive, and assemble the HDD bracket with HDD back into the chassis. The connector of the hard drive should be at the opposite side of the power switch after installation.

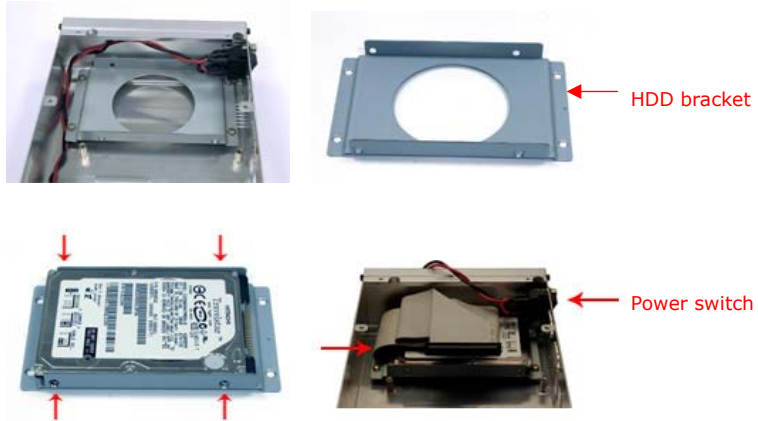

**Step 4**

An optional 40mm cooling fan can accommodate in EBC-2100. The arrow sign on the cooling fan indicates the direction of airflow and it should point outside the chassis.

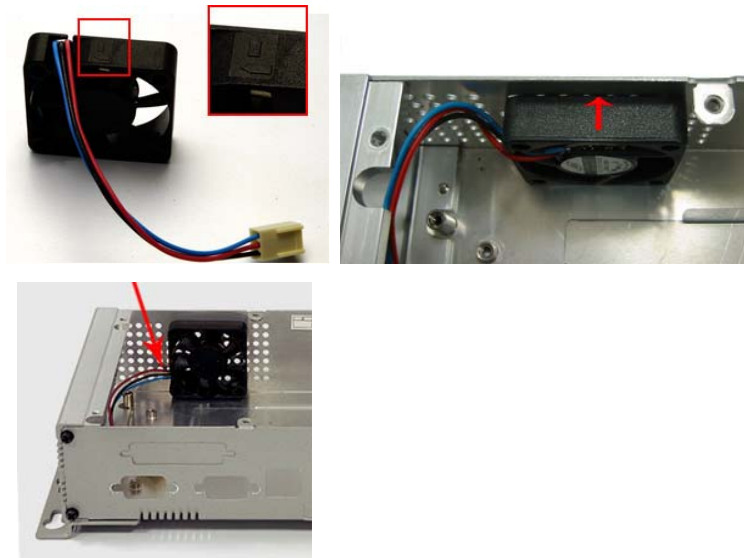

**Step 5**

Before installing CPU board into the chassis, CPU, Memory, heatsink and CPU cooling fan must be secured properly onto the CPU board. To prevent heatsink deformation, please handle the heatsink diagonally.

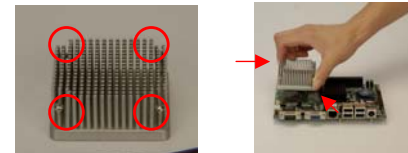

**Step 6**

Unscrew the COM port/VGA port with proper tool.

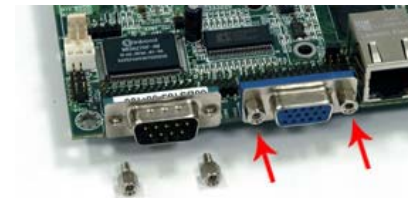

**Step 7**

Align the motherboard with the chassis standoffs, secure with screws for motherboard and COM port and VGA port.

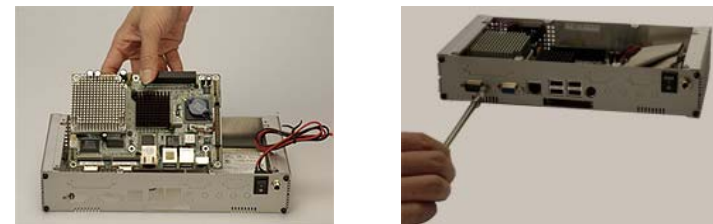

**Step 8**

Align the power cable into the embedded board.

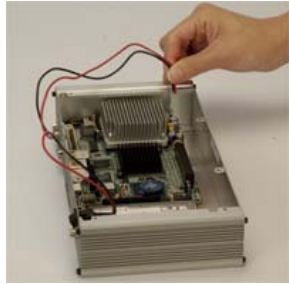
**Step 9**

Place the cover back on the top of the case and secure with screws.

**Step 10**

If wall mounting is required, secure the wall mounting kits to the bottom of the chassis with screws. For desktop usage please apply the rubber foot pads to the bottom of the chassis.

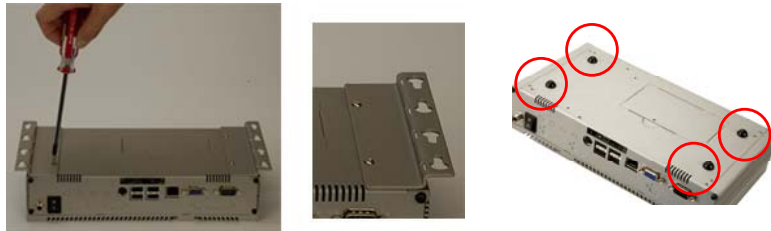
**Step 11**

When replacing the system memory, simply remove the screws on the bottom cover then insert the memory to the memory slot. Then place the cover back on the chassis and secure with screws.

**Contact Information****IEI Technology Corp.**

TEL : 886-2-86916798

FAX : 886-2-66160029

Email: [sales@iei.com.tw](mailto:sales@iei.com.tw)

Website: <http://www.ieworld.com>

Address: No. 29, Jhongsing Rd., Sijhih City, Taipei County, 221, Taiwan